

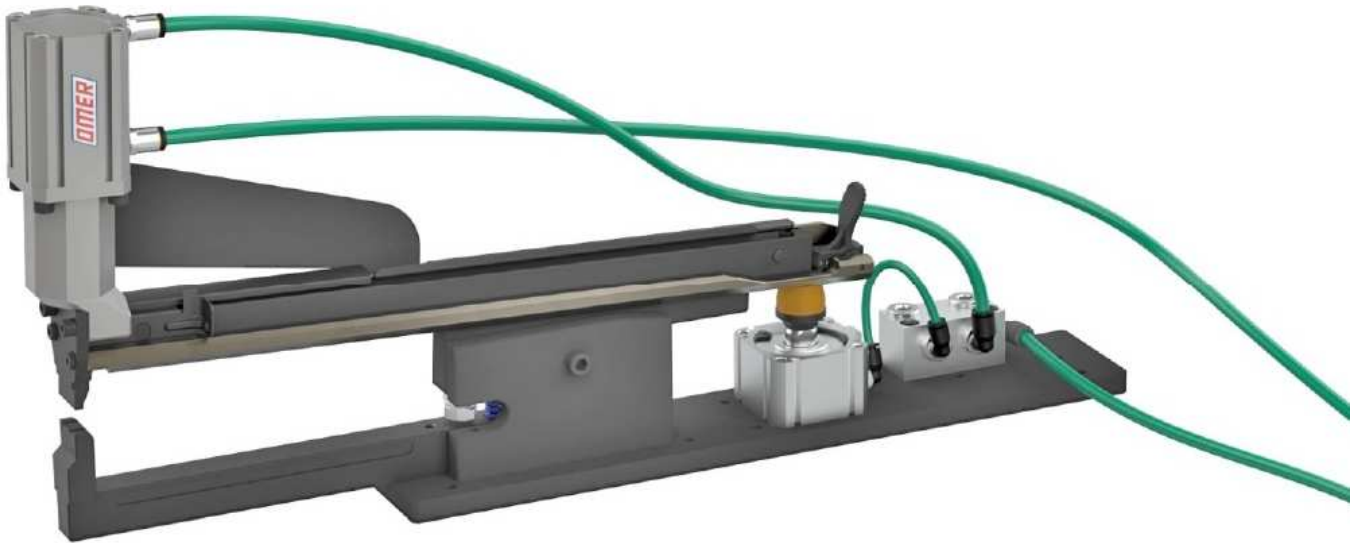

26.8 ROPB-3

USE, MAINTENANCE & SPARE PARTS MANUAL



TECHNICAL DATA		
Lengths mm	6 ÷ 8	Type of Fastener Gauge: 25½ Crown: .503" (1/2")
Magazine capacity	500	
Operating pressure	5 ÷ 6 bar 80 ÷ 95 psi	
Air consumption litres/shot	0.90	
Weight kg	4.55	
Sound power emitted	83 dB(A)	
		Feb 2022

Adjustment of front side opening

A front side opening adjustment must be carried out to allow an easy insertion of the material to be fastened.

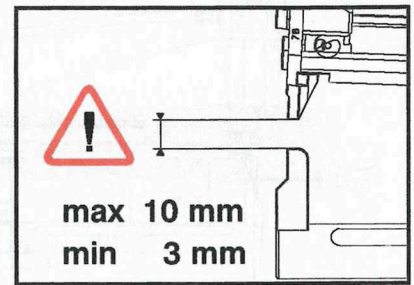
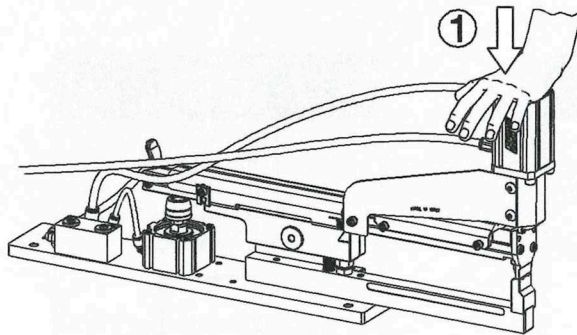

1 - Press the stapler head and keep this position to gain access to the pneumatic cylinder and bumper.

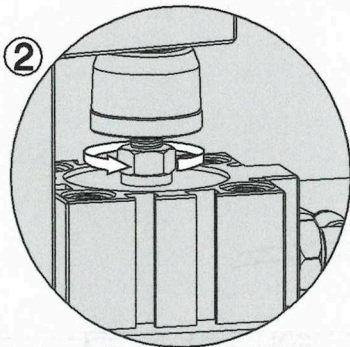
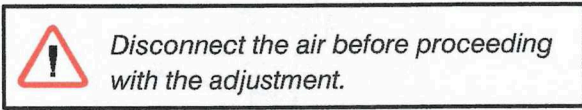

2 - Loosen the nut.

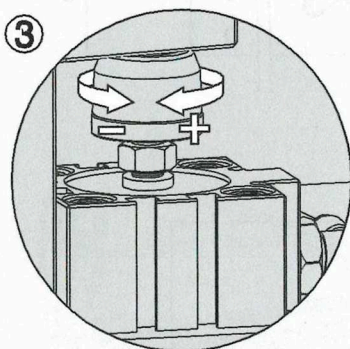
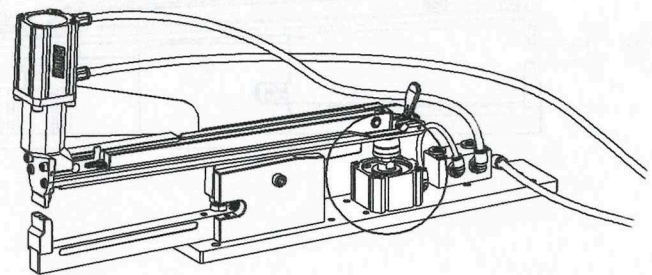

3 - Screw/unscrew the bumper to increase/decrease the opening

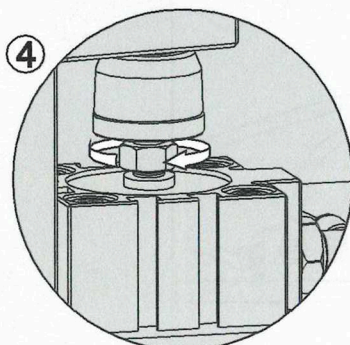
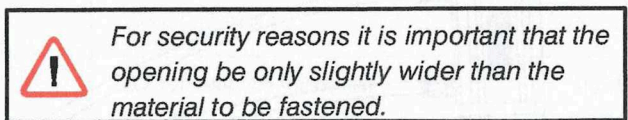

4 - Tighten the nut.

Clinching depth adjustment

To avoid flattening/damaging the material to be fastened it is possible to set the clinching depth by adjusting the end-run screw.



Disconnect the air before proceeding with the adjustment.

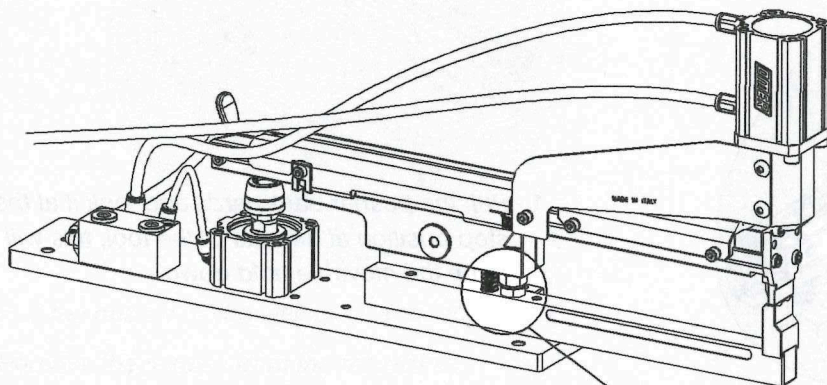

max 4 mm
min 0,5 mm

①

1 - Loosen the nut which stops the end-run screw.

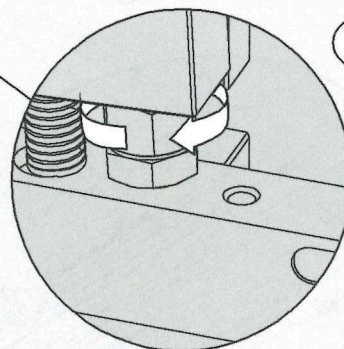

②

2 - Screw or unscrew the end-run screw to adjust the clinching depth.

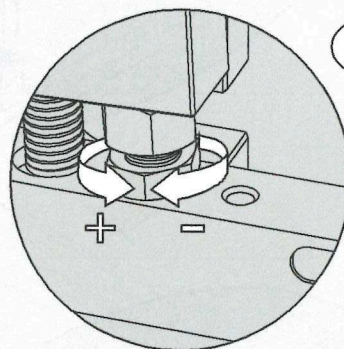
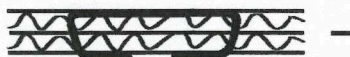

③

3 - Tighten the locking nut.

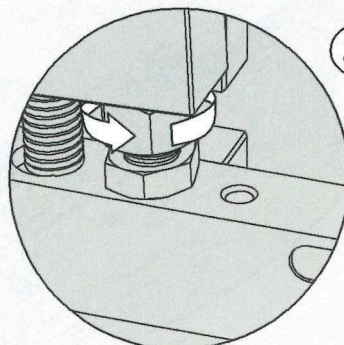

Jam-clearing

In case of jamming, proceed as follows:

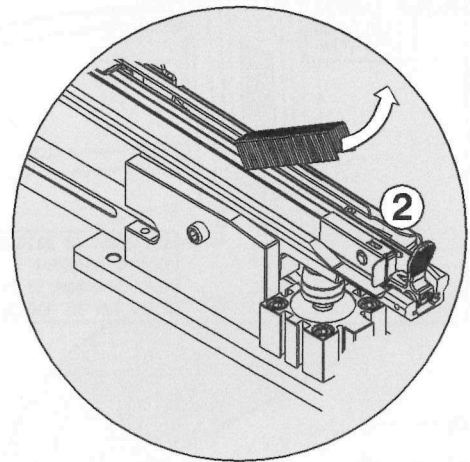
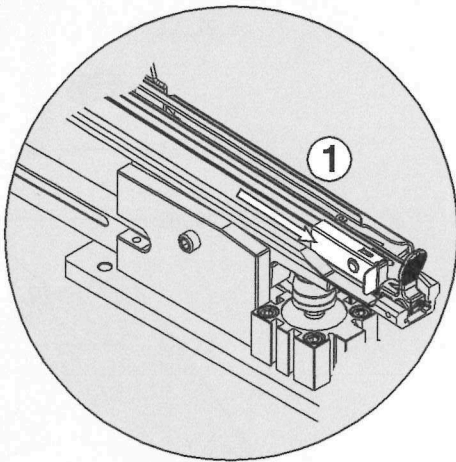

- 1 - Pull the pusher all the way back and lock it.
- 2 - Remove the staples from the magazine.

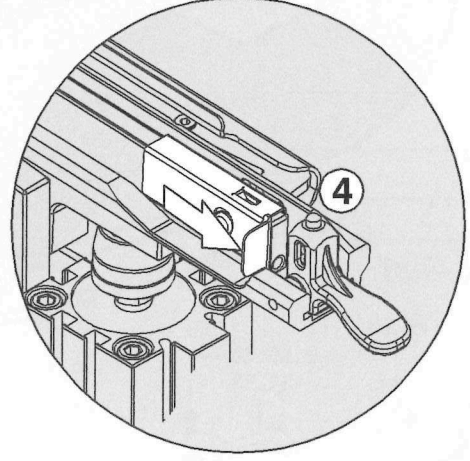
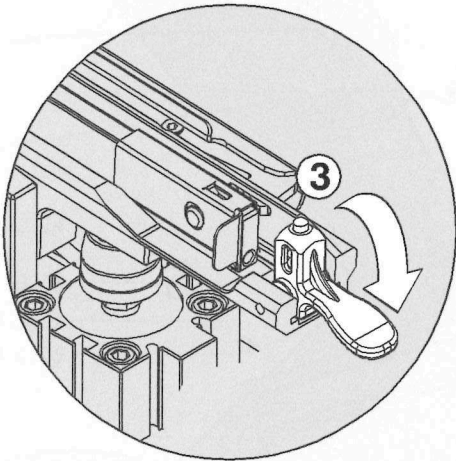

- 3 - Open the slider closing trigger.
- 4 - Pull the slider all the way back by acting on the pusher and holding it in such a position.

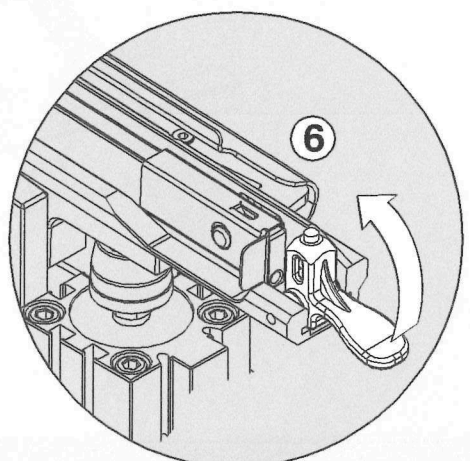
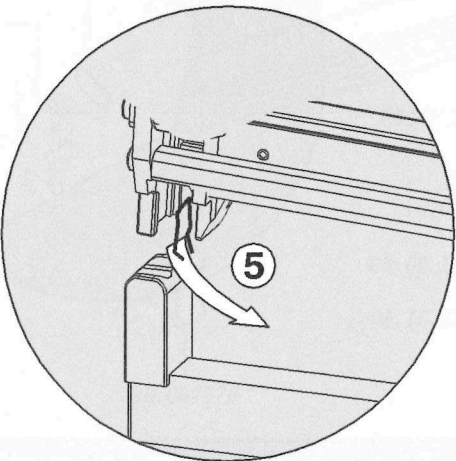

- 5 - Pull the jammed staple out from the firing channel.
- 6 - Release the slider and block closing trigger.
- 7 - Load the tool regularly.

Spare parts

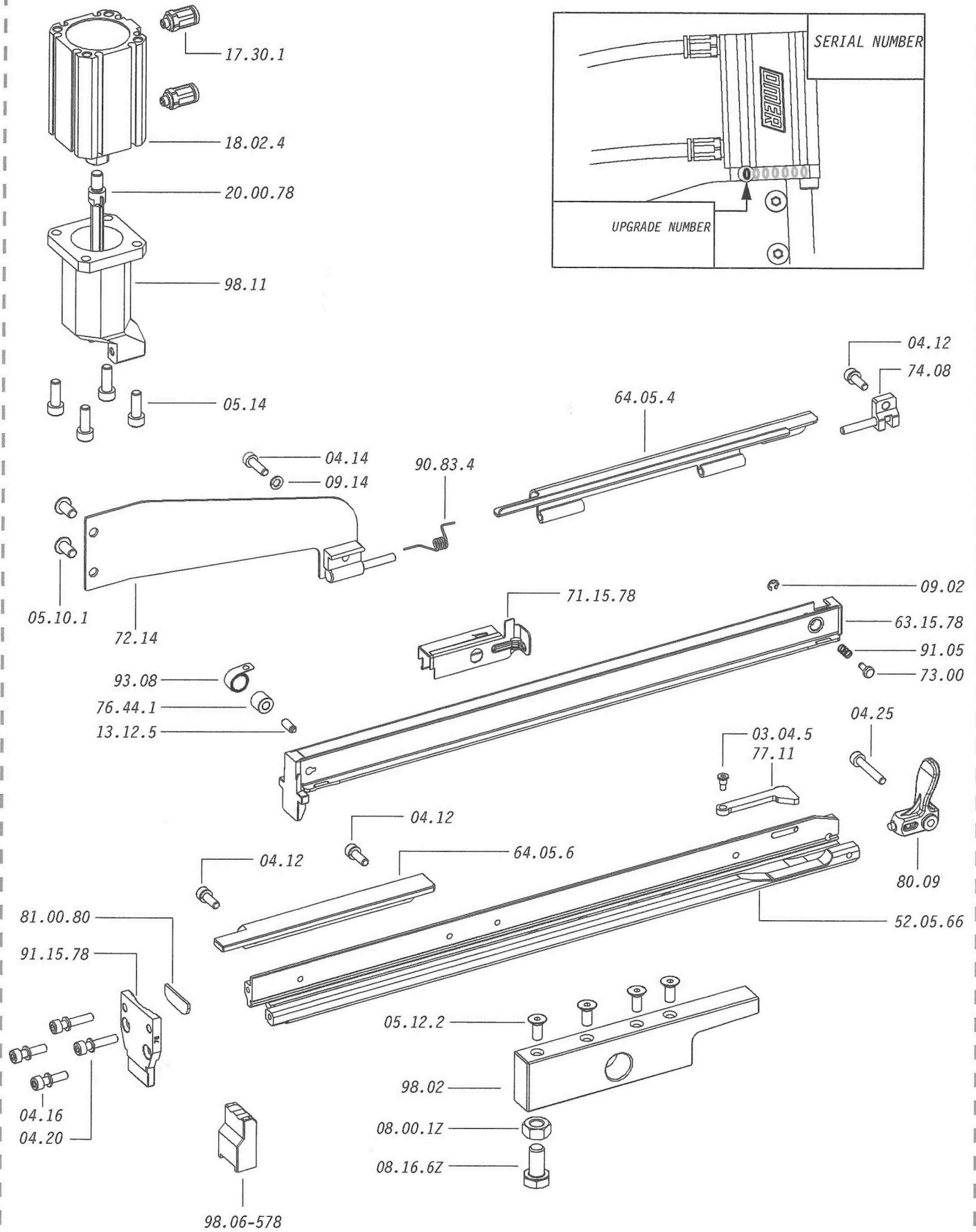

Spare parts

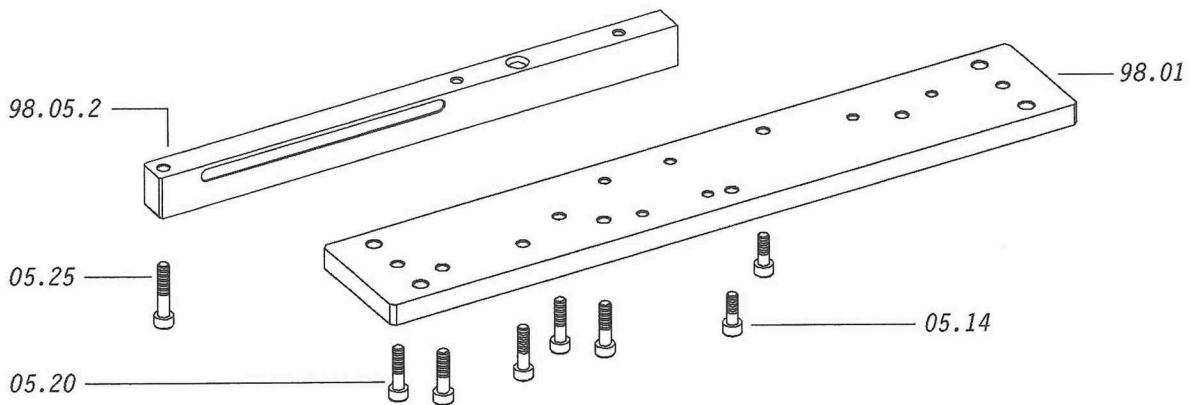
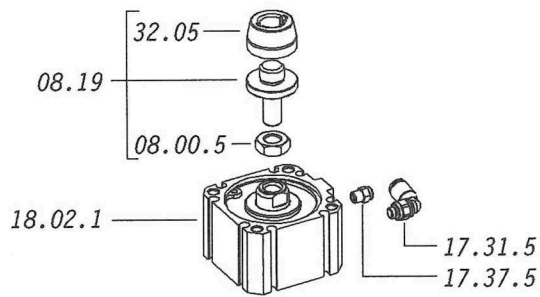
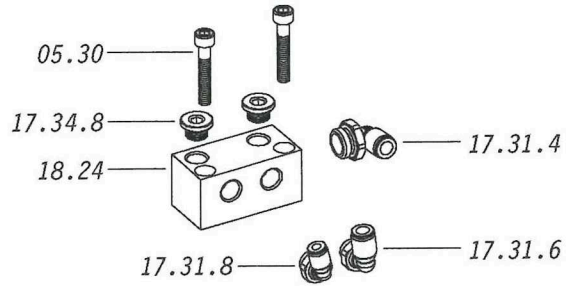
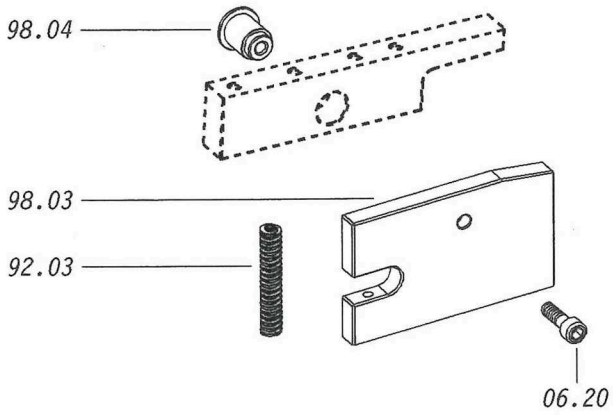

Connetion tubes

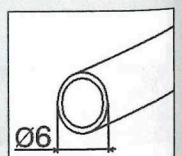
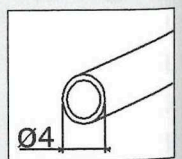

Pneumatic diagram

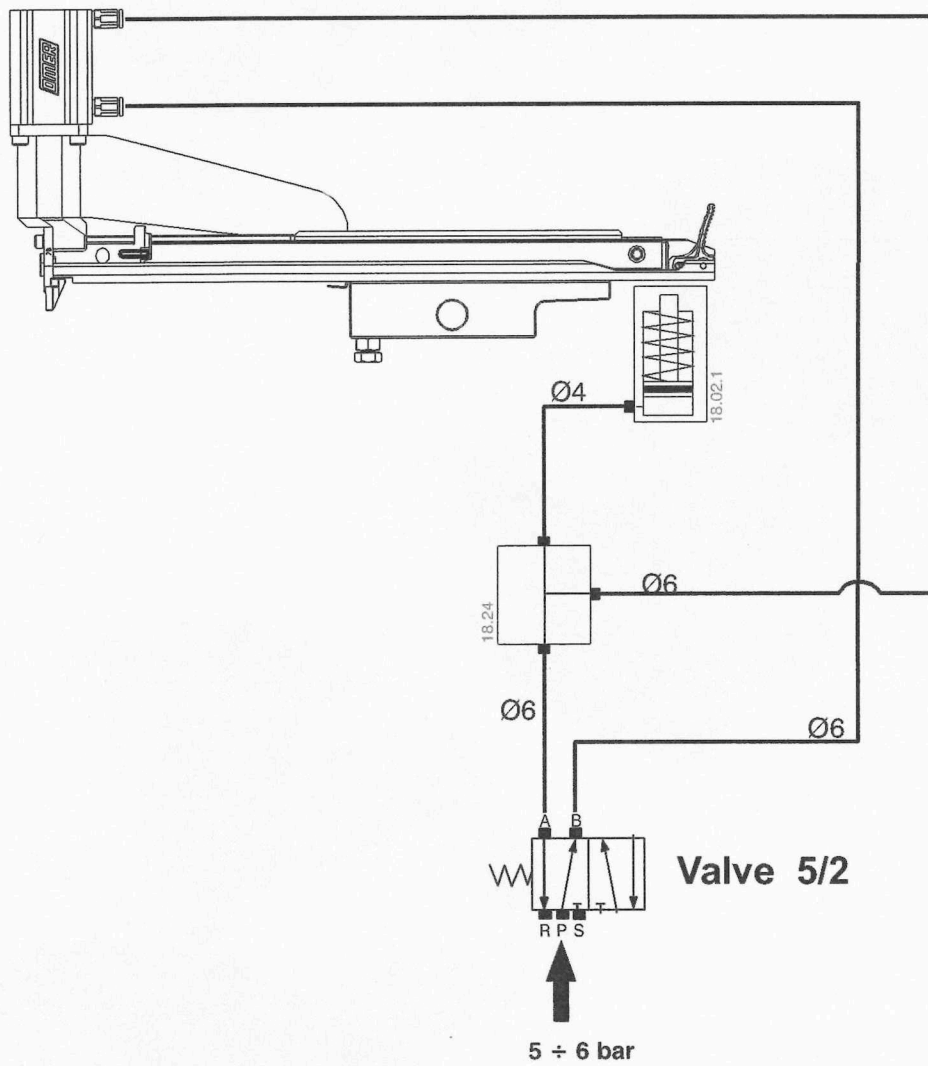
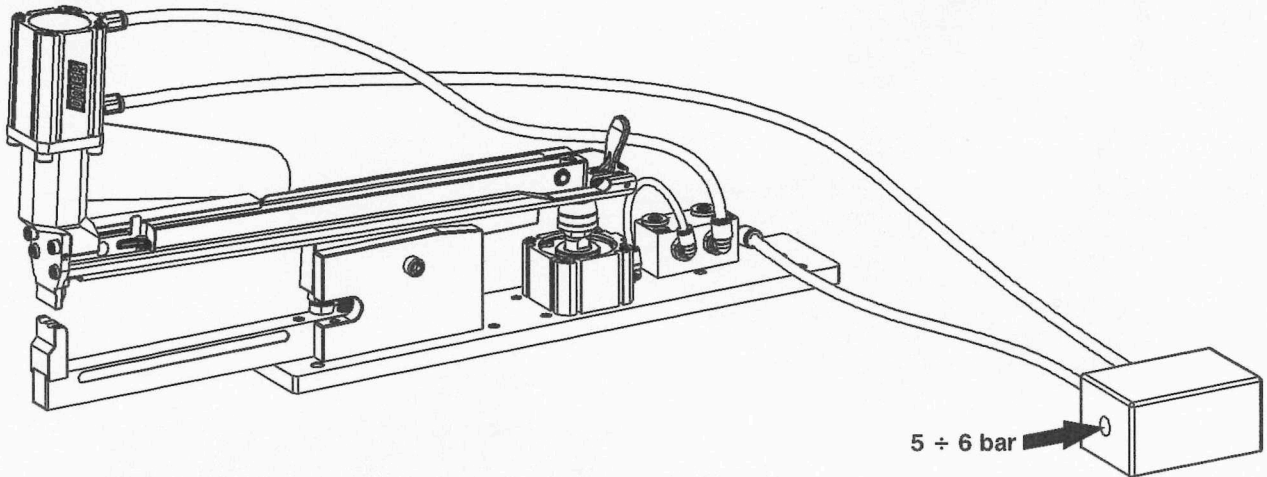

Spare parts list

Cod.	Description	Cod.	Description
03.04.5	Screw	18.02.1	Pneumatic Cylinder
04.12	Screw	18.24	Distributor
04.14	Screw	32.05	Bumper
04.16	Screw	43.11	Washer
04.20	Screw	64.05.4	Hold down
04.25	Screw	64.05.6	Hold down
05.10.1	Screw	72.14	Support
05.12.2	Screw	73.00	Pin
05.14	Screw	74.08	Support
05.20	Screw	76.44.1	Roll spring
05.25	Screw	77.11	Lever
05.30	Screw	80.09	Trigger
06.20	Screw	90.83.4	Spring
07.25	Hex. bar wrench	91.05	Spring
07.30	Hex. bar wrench	92.03	Spring
07.40	Hex. bar wrench	93.08	Spring
07.50	Hex. bar wrench	98.01	Base Plate
08.00.1Z	Nut	98.02	Hinge
08.00.5	Nut	98.03	Support
08.16.6Z	Screw	98.04	Pin
08.19	Bumper ass'y	98.05.2	Staff
09.02	Elastic ring	98.06-578	Anvil
09.14	Washer	98.11	Support
13.12.5	Pin	20.00.78	Driver
17.30.1	Conn. "Straight" 6 - M5	52.05.66	Magazine
17.31.4	Conn. "Elbow" 6 - G1/4	63.15.78	Slider
17.31.5	Conn. "Elbow" 4 - M5	71.15.78	Pusher
17.31.6	Conn. "Elbow" 6 - G1/8	81.04.80	Nose
17.31.8	Conn. "Elbow" 4 - G1/8	91.15.78	Nose plate
17.34.8	Cap	D01	Oiler
17.37.5	Silencer		

Accessories

